

Submittal Data Sheet

Wilo Stratos GIGA – High Efficiency Inline Circulators

wilo®

Stratos GIGA 1.5/3-80

	Project:						
	Engineer:						
	Contractor:						
	Submitted By:				Date:		
	Approved By:				Date:		
Tag #	Model #	Flow	Head	Control Mode	Cycle	Phase	Voltage
	Stratos GIGA 1.5/3-80					3	

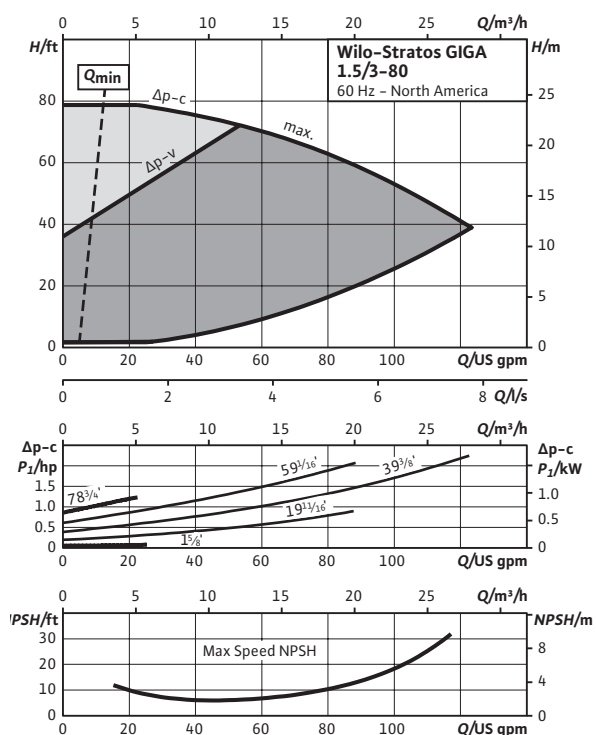
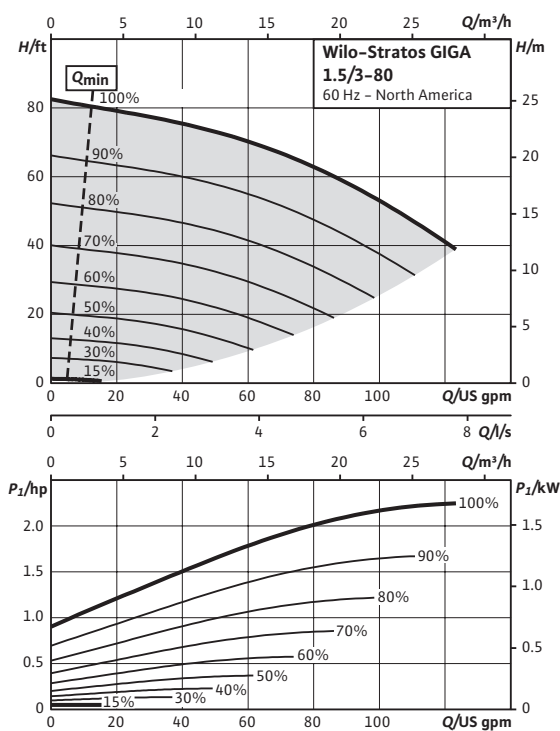

Technical Data	
Liquid Temp Range	-4°F to 284°F (-20°C to +140°C)
Fluid Capatability	Water 50/50 Water-Glycol Mixtures
Max Operating Pressure	189 PSI, 284°F (140°C) 232 PSI, 248°F (120°C)
Mains Voltage	380-480V±10% 50/60Hz
Protection Class	IP 55, Class F Insulation
Ambient Temp Range	32°F to 104°F (0°C to 40°C)
Max Relative Humidity	32°F to 86°F (0°C to 30°C): 90% 87°F to 104°F (31°C to 40°C): 60%
Sound Level	< 74 dBA

Materials of Construction	
Pump Volute	Cast Iron Cataphoresis Coated (ASTM A48 / EN-GJL-250)
Impeller	Composite (PPS-GF40) Integral Stainless Inlet
Shaft	Stainless Steel (AISI 420 / 1.4122)
Mechanical seal	SiC/EPDM

IR Module Selection		
Module 1	Module 2	Module
		BACnet / Dual Pump
		LONworks / Dual Pump
		MODBus
		None

Applications	
• Hot Water Heating Systems	• Closed Cooling Circuits
• Industrial Circulation Systems	• Air-conditioning Systems
• Solar	• Geothermal

Approval Stamp

Submittal Data Sheet

Wilo Stratos GIGA – High Efficiency Inline Circulators

wilo®

Dimensions & Weights

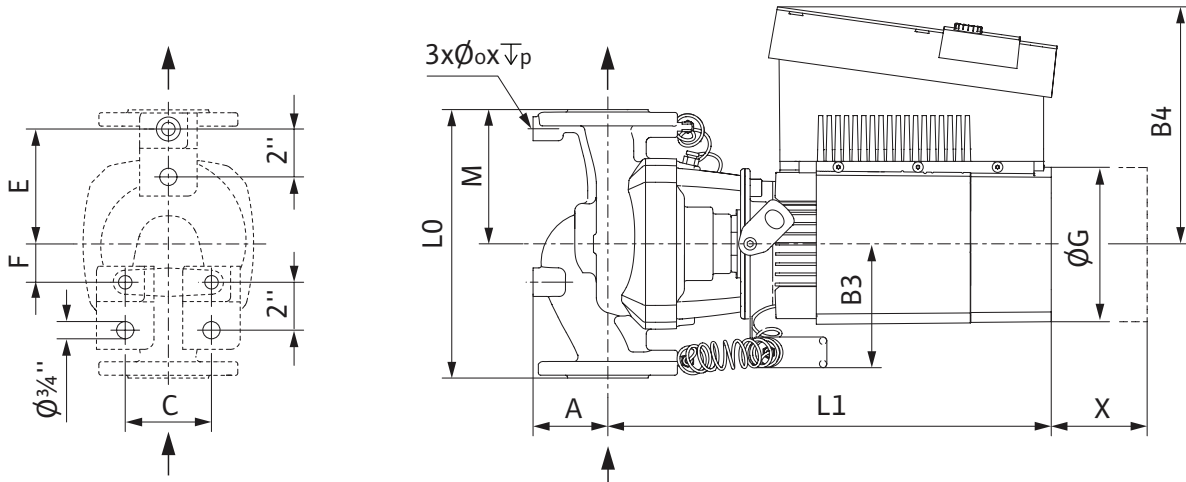

Dimensions and Weights

Dimensions – Inches (mm)																	Weight lbs (kg)
Model	I ₀	A	B1	B2	B3	B4	C	E	F	ØG	H	L1	M	O	P	X	
Stratos GIGA 1.5/3-80	11½	3¾	3½	3½	5⅛	9¾	3⅝	4⅞	1⅝	6⅝	10⅞	18¼	5½	½	¾	8⅞	89
	(292)	(86)	(89)	(89)	(129)	(248)	(92)	(124)	(41)	(168)	(277)	(463)	(140)	(13)	(19)	(225)	(41)

Flange Dimensions – 125#ANSI

Dimensions – Inches (mm)				
Dia.	ØD	Ød	Øk	n x Ød _L
1.5"	6⅞	3⅞	3⅞	4 x ⅝
	(155)	(90)	(99)	(4 x 16)

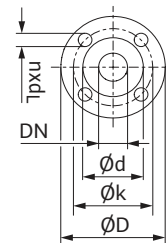

ECM Motor Data (Single Motor Operation)

		P ₂ Rated	P ₁	Speed	FLA
Model	hp	kW	RPM	3~460V	
Stratos GIGA 1.5/3-80	2.0	1.7	500-4000	2.0A	

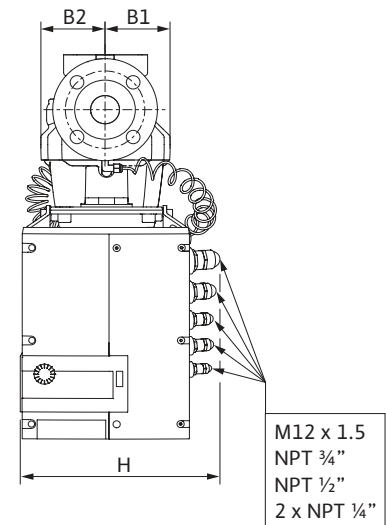
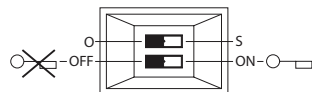
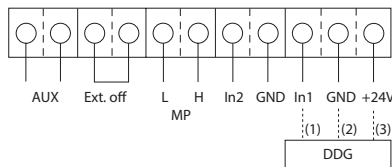
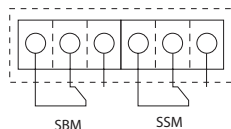
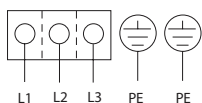

WILO USA LLC

Tel: (888) 945-6872 Web: www.wilo-usa.com
Fax: (888) 945-6873 Email: info@wilo-usa.com

WILO Canada Inc.

Tel: (866) 945-6236 Web: www.wilo-canada.com
Fax: (403) 277-9456 Email: info@wilo-canada.com

WILO Mexico

Tel: +52 55 5586 3209 Web: www.wilo-mexico.com.mx
Fax: +52 1 55 5413 4165 Email: info@wilo.com.mx